

## IC SOCKET, PRESS PIN, PITCH 1.778, ROW SPACE 7.62, WITHOUT BEAM

### Material and Finish

Insulator: PBT, UL 94V-0  
 Contact: Phosphor Bronze, Thickness 0.17mm  
 Contact Plated: Sn-Cu plated  
 Operating Temperature: -25°C ~ +85°C

### Electrical

Contact Current Rating: 1 AMP.  
 Contact Resistance: 30M ohms Max.  
 Insulator Resistance: 5000M ohms Min.  
 Dielectric Withstanding: 1000V AC RMS for 1 minute.

### Mechanical

Insertion Force: 340g Max/ Pin  
 Extraction Force: 14.5g Min/ Pin

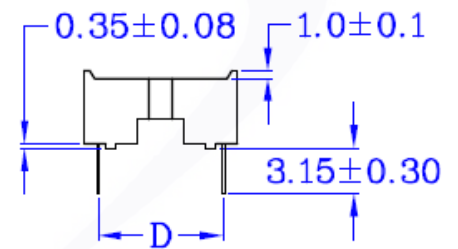
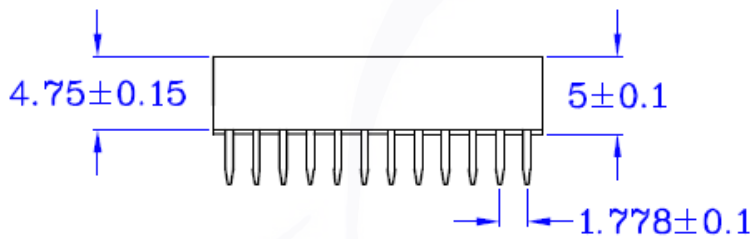
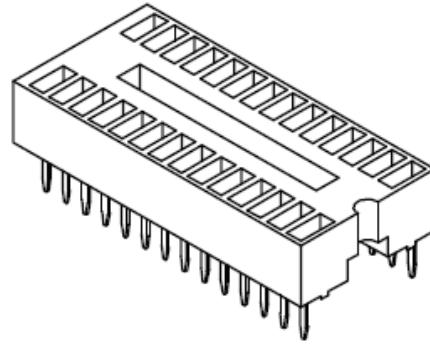
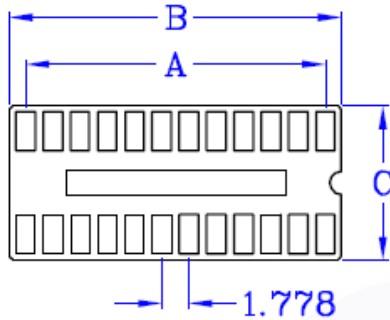

CONTACTS	A±0.20	B±0.20	C±0.20	D±0.20
16	12.45	14.22	10.10	7.62
20	16.00	17.78		
22	17.78	19.56		
24	19.56	21.34		

Series	Pitch	Row	No. of Pin	Beam	Thickness of Pin	Plating	Packing	Status
IC-	[1] 1.778	[1] 7.62	--	[0] W/O	[2] 0.17	[T0] TIN PLATED, LIGHT TIN	[G] BAG [X] BOX [R] REEL [U] TUBE [Y] TRAY	[R] RoHS