

HDMI CONNECTOR, 19PINS, FEMALE, DIP CONTACT, DIP GROUNDING, THREE ROWS

Material and Finish

Housing: Hi-Temp plastic, UL94V-0

Contact: Copper Alloy, T= 0.20mm.

Shell: Copper Alloy, T= 0.50mm. (BRASS)

Mechanical

Operating Temperature: -20°C~ +85°C

Electrical

Contact Current Rating: 0.5 AMP..

Dielectric Withstanding Voltage: 300V AC RMS.

Insulation Resistance: 100M ohms Min.

Contact Resistance: 30M ohms Max.

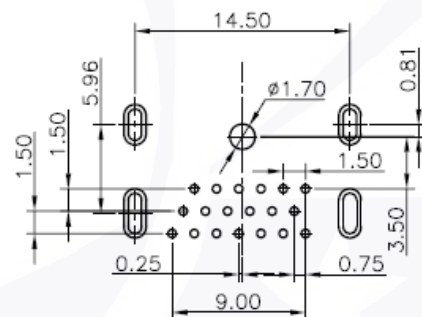
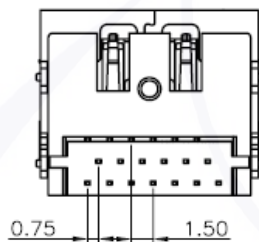
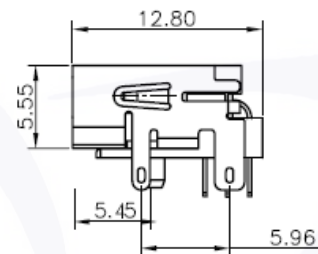
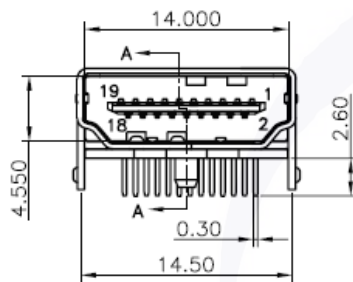
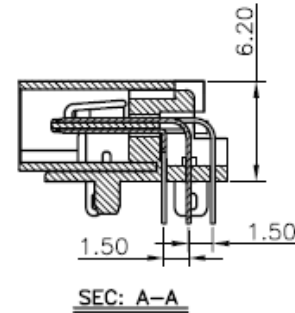
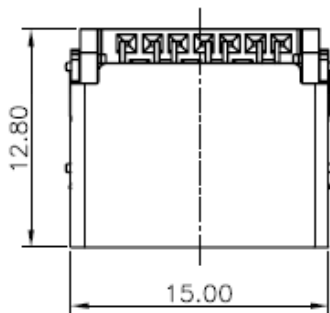

RECOMMENDED P.C BOARD LAYOUT

| Series- | No. Pins | Type | Contact | Grounding | Shell Type | Plating- | Color | Packing- | Option- | Status- |
|---------|-----------|------------|---------|-----------|----------------|--------------------------------------------------------------------|------------------------|--------------------------------------------------------|---------|---------|
| HD- | 1- [A] 19 | [F] FEMALE | [D] DIP | [D] DIP | [0] W/O FLANGE | [T5] SELECTIVE GOLD PLATED 5u" [T15] SELECTIVE GOLD PLATED 15u" | [0] BLACK [1] WHITE | [G] BAG [X] BOX [R] REEL [U] TUBE [Y] TRAY | | [R]RoHS |