

D-SUB CONNECTOR, SOLDER TYPE, STRAIGHT, WITHOUT SCREW

Material

Insulator: Glass-Filled Thermoplastic PBT, UL94V-0
 Contact: Brass
 Shell: Steel, 100u" Tin Over 50u" min Copper
 Clinch Nut: Brass, Nickel Plated
 Boardlock: Brass, Tin Plated
 Screwlock: Brass, Nickel Plated

Electrical

Contact Resistance: 20 milliohms, Max at 1 AMP DC.
 Insulation Resistance: 1000, magohms at 500V DC
 Dielectric Withstanding Voltage: 1000V AC/rms 60Hz for 1 minute
 Current Rating: 3.0 AMP
 Volatge Rating: 250V AC/rms 60Hz

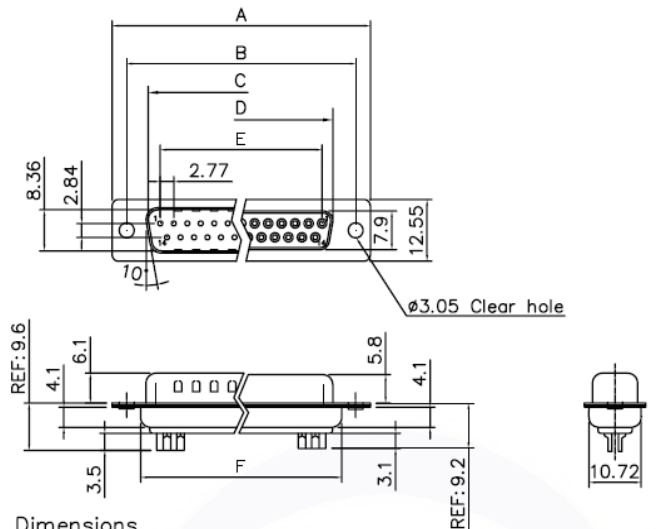

Dimensions

Positions	A	B	C	D	E	F
9	30.81	24.99	16.92	16.33	11.08	19.20
15	39.20	33.30	25.25	24.70	19.39	27.70
25	53.05	47.04	38.96	38.40	33.24	41.10
37	69.40	63.50	55.42	54.80	49.86	57.30

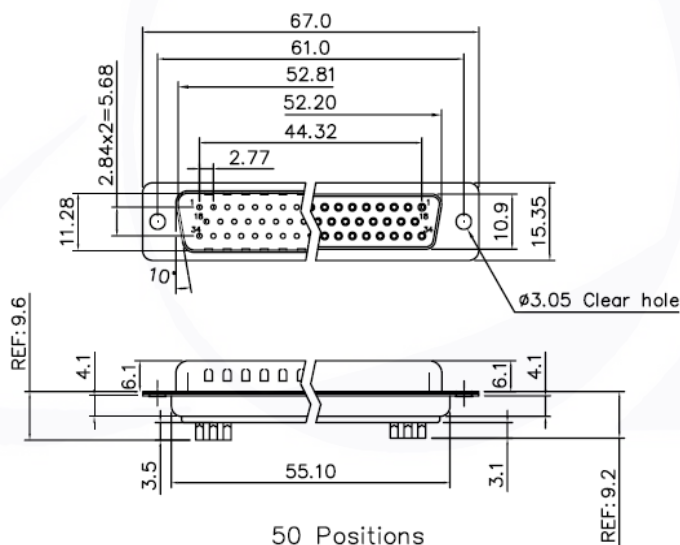

50 Positions

Series-	Type-	NO. Pins-	Angle-	Screw-	Color-	Plating-	Packing-	Option-	Status-
DBM- (Male)	1- [2] SOLDER TYPE	9	[S] 180°	[0] W/O	[0] BLACK	[T1] SELECTIVE GOLD PLATED 1u"	[G] BAG		[R]RoHS
		15		[1] LOCKED	[4] BLUE	[T15] SELECTIVE GOLD PLATED 15u"	[X] BOX		
		25		[2] UNLOCKED			[R] REEL		
		37					[U] TUBE		
DBF- (Female)		50					[Y] TRAY		