

D-SUB CONNECTOR, HIGH DENSITY, PCB TYPE, FEMALE, RIGHT ANGLE, 8.89mm

Material

Contacts: Brass
 Insulator: PBT +30%, UL 94V-0
 Shell: Steel

Mechanical

Contact insertion force: 300gf Max.
 Contact separation force: 25gf Min.

Electrical

Contact current rating: 3 AMP
 Dielectric withstanding voltage: AC 1000/ 60sec rms.
 Insulation resistance: 5000m ohms Min. at DC 500V.
 Contact resistance: 25m ohms Max.
 Operating temperature: -55°C ~ +105°C

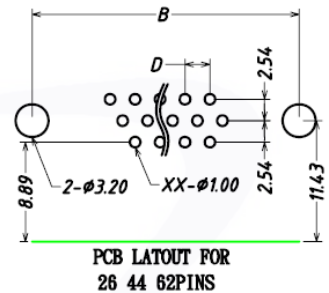
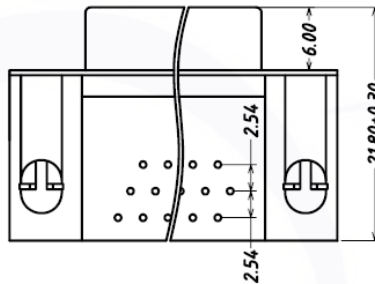
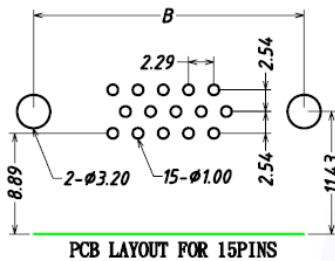
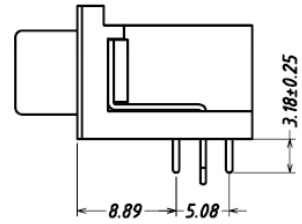
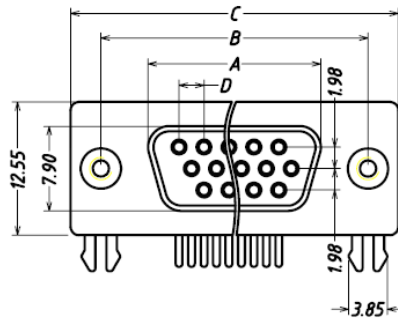
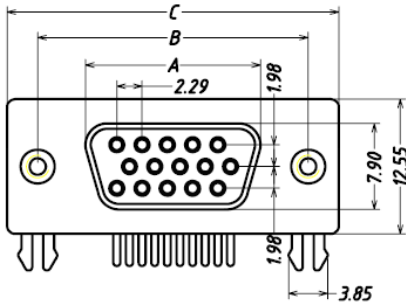

NUMBER OF CONTACTS	A ±0.25	B ±0.13	C ±0.38	D ±0.05
15	16.33	24.99	30.85	2.29
26	24.66	33.32	39.14	2.29
44	38.38	47.04	53.04	2.29
62	54.84	63.50	69.32	2.41

Series-	Type-	NO. Pins-	Angle-	Screw-	Color-	Plating-	Packing-	Footprint	Option-	Status-
DHF-- (High-Density, FEMALE)	[1] PCB TYPE	15	[R] 90°	[0] W/O	[1] WHITE	[T1] SELECTIVE GOLD PLATED 1u"	[G] BAG	[1] 5.08		[R] RoHS
		26		[1] LOCKED	[4] BLUE	[T15] SELECTIVE GOLD PLATED 15u"	[X] BOX	[2] 8.08		
		44		[2] UNLOCKED		[G1] FULL GOLD PLATED 1u"	[R] REEL	[3] 8.89		
		62				[G3] FULL GOLD PLATED 3u"	[U] TUBE	[4] 10.3		
							[Y] TRAY	[5] 13.48		
								[6] 14.90		