

## WAFER CONNECTOR, PITCH 1.00, SMT, RIGHT ANGLE, SINGLE ROW, CRIMP STYLE

### Material and Finish

Contact: Phos. Bronze  
 Fitting Nail: Brass, Tin Plated  
 Notch for Cap Stopper (Straight)

### Electrical

Current Rating: 1A AC/DC  
 Withstanding Voltage: 500V AC for 1 minute.  
 Insulation Resistance: 100M ohms Min.  
 Temperature Range: -25°C ~ +85°C  
 Contact Resistance: 20m ohms Max.

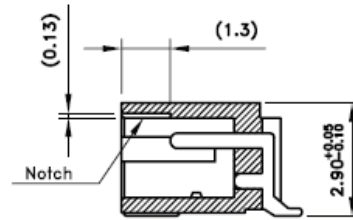
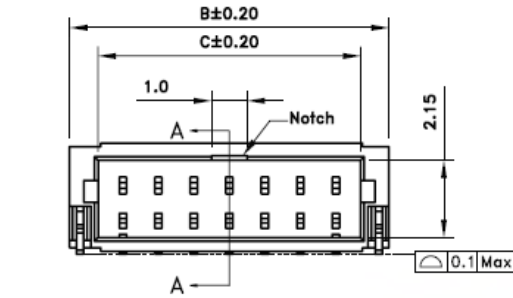
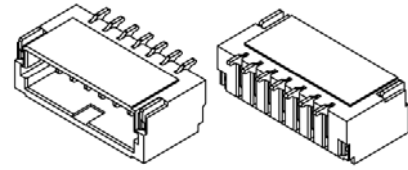

Section A-A 5 Circuit

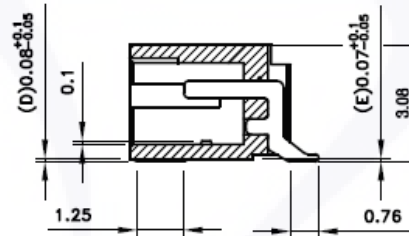
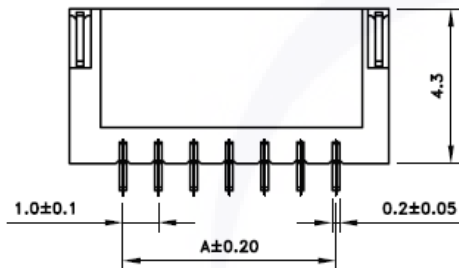

Section A-A 2~4 & 6~22 Circuit

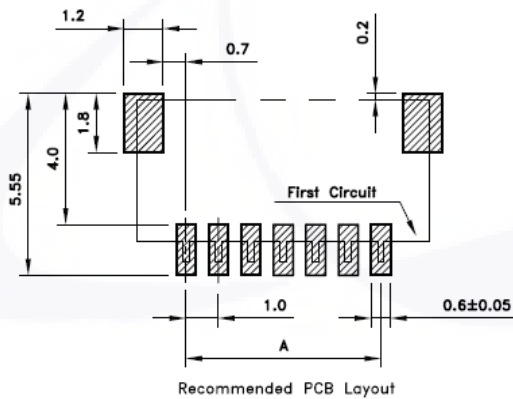

Recommended PCB Layout

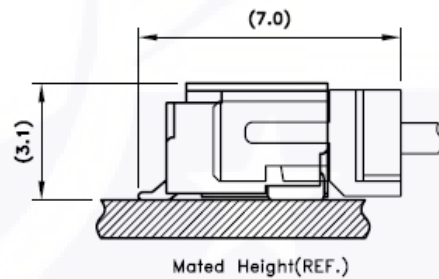

Mated Height(REF.)

Poles	Dimensions (mm)			Poles	Dimensions (mm)		
	A	B	C		A	B	C
2	1.00	4.00	2.45	13	12.00	15.00	13.45
3	2.00	5.00	3.45	14	13.00	16.00	14.45
4	3.00	6.00	4.45	15	14.00	17.00	15.45
5	4.00	7.00	5.45	16	15.00	18.00	16.45
6	5.00	8.00	6.45	17	16.00	19.00	17.45
7	6.00	9.00	7.45	18	17.00	20.00	18.45
8	7.00	10.00	8.45	19	18.00	21.00	19.45
9	8.00	11.00	9.45	20	19.00	22.00	20.45
10	9.00	12.00	10.45	21	20.00	23.00	21.45
11	10.00	13.00	11.45	22	21.00	24.00	22.45
12	11.00	14.00	12.45				

Series	Free Code	Pitch	Style	Plating
WFC	1-	[A] 1.00mm	[RM] 90°SMT	[T0] TIN PLATED