

WAFER CONNECTOR, PITCH 1.25, DIP, STRAIGHT, SINGLE ROW, CRIMP STYLE

Material and Finish

Contact: Brass, Tin plated
Base: Nylon 66, UL 94V-0

Electrical

Voltage Rating: 125V AC/DC
Current Rating: 1A AC/DC
Withstanding Voltage: 250V AC RMS for 1 minute.
Insulation Resistance: 100M ohms Min.
Temperature Range: -40°C ~ +85°C
Contact Resistance: 20M ohms Max.

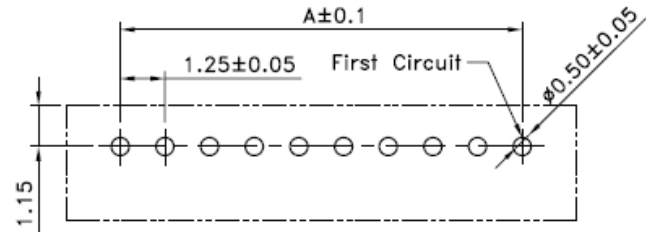
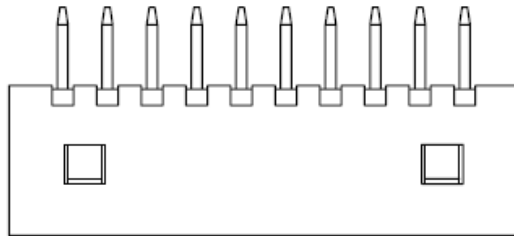

Recommended PCB Layout(Top View)

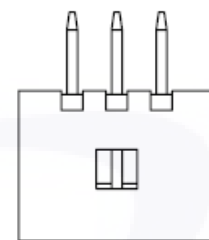
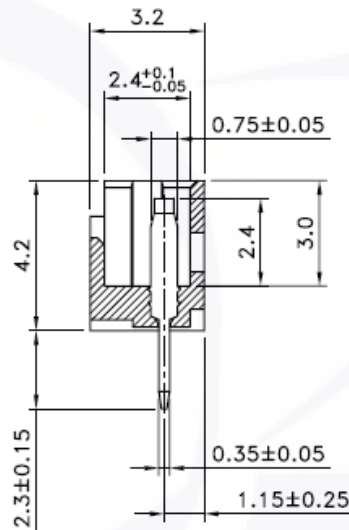
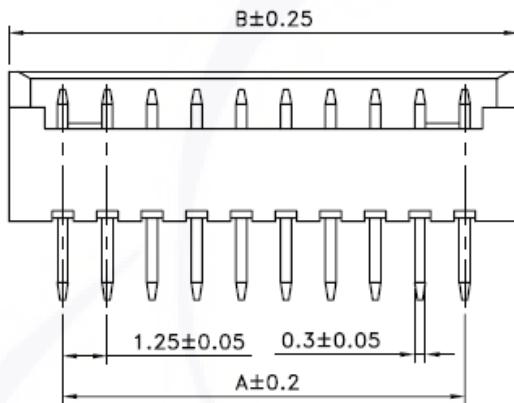
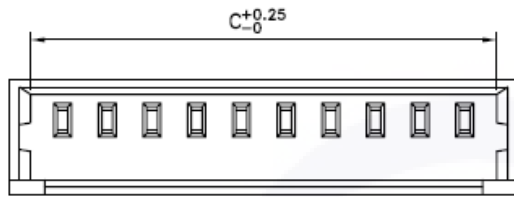

3 Circuit

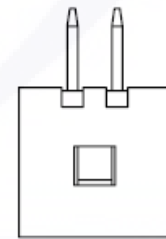

2 Circuit

Poles	Dimensions (mm)		
	A	B	C
2	1.25	4.25	3.05
3	2.50	5.50	4.30
4	3.75	6.75	5.55
5	5.00	8.00	6.80
6	6.25	9.25	8.05
7	7.50	10.50	9.30
8	8.75	11.75	10.55
9	10.00	13.00	11.80
10	11.25	14.25	13.05
11	12.50	15.50	14.30
12	13.75	16.75	15.55
13	15.00	18.00	16.80
14	16.25	19.25	18.05
15	17.50	20.50	19.30

Series	Free Code	Pitch	Style	Row Option	No. Pins Per Row	Color	Plating	Packing	Status
WFC	1-	[B] 1.25mm	[S] 180°/DIP	[S] SINGLE ROW	XX	[1] WHITE [11] IVORY [12] BEIGE [2] TRANSPARENT	[T0] TIN PLATED	[X] BOX	[R] RoHS